

NOTES :

1. WATER SERVICING COORDINATOR & DESIGNER  
CALIBRE PROFESSIONAL SERVICES PTY LTD  
P.O. BOX 8300 Baulkham Hills BC NSW 2153  
Ph: (02) 8808 5000  
  
FOR:  
REDBANK COMMUNITIES  
76 ARTHUR PHILLIP DRIVE  
NORTH RICHMOND NSW 2754
  2. THE WORKS AND MATERIALS ARE IN ACCORDANCE WITH THE SEWERAGE CODE OF AUSTRALIA (WSA 02-2002-2.2 VERSION 4-2017).
  3. ALL LOTS WERE VACANT AT TIME OF SURVEY.
  4. ALL STRUCTURES CONSTRUCTED TO PROPOSED FINISHED SURFACE LEVELS. AS THE P.F.S.L.'S SHOWN ON THIS PLAN MAY BE SUBJECT TO CHANGE, THE CONSTRUCTOR WAS TO LIAISE WITH THE SITE SUPERINTENDENT TO VERIFY ALL FINAL LEVELS AT TIME OF CONSTRUCTION.
  5. PIPES CONCRETE ENCASED SHOWN ACCORDINGLY:
  6. AREAS HATCHED THUS NOT DRAINED:
  7. DRAINAGE LIMITS ARE TO PROPOSED FINISHED SURFACE LEVELS.
  8. ALL LEVELS ELECTRONICALLY GENERATED. NO LEVEL BOOK AVAILABLE.
  9. ALL MAINS LAID IN EXISTING, PROPOSED OR FUTURE ROAD CARRIAGEWAYS - SEE SITE SPECIFIC COMPACTION SPECIFICATION - REFER SHEET 2
  10. THE MINIMUM NUMBER OF FIELD COMPACTION TESTS REQUIRED TO SATISFY THE SEWERAGE CODE OF AUSTRALIA (CLAUSE 22.3.4.4) WERE:  
  
PIPE EMBEDMENT ZONE: - NIL TRENCH FILL ZONE - TRAFFICABLE: NIL (SEE NOTE 9)  
(SEE NOTE 13) TRENCH FILL ZONE - NON-TRAFFICABLE: 42  
M.H. & M.S. ZONE: 45  
  
(PLEASE REFER TO SITE SPECIFIC COMPACTION SPECIFICATION - REFER SHEET 2)
  11. ALL PROPERTY CONNECTION SEWERS CONSTRUCTED AS DETAILED IN DTC-2120 (Iss. A, 18/03/15).
  12. EMBEDMENT COMPACTION TESTING AS PER SITE SPECIFIC COMPACTION SPECIFICATION (REFER SHEET 2) AND SUBJECT TO CLAUSE 22.3.3.1 OF SEWERAGE CODE OF AUSTRALIA. SELF-COMPACTING METAL GRANULAR EMBEDMENT MAY HAVE BEEN USED.
  13. WHERE MAINTENANCE SHAFTS HAVE A DEFLECTION GREATER THAN 30 DEGREES, 'POO PIT' TYPE WERE INSTALLED. THE DEFLECTION ANGLE (D.A.) FOR EACH MAINTENANCE SHAFT IS SHOWN ON THE MAINTENANCE STRUCTURE SCHEDULE (SHEET 2)
  14. ALL M.H.'S CONSTRUCTED IN ACCORDANCE WITH SYDNEY WATER'S DEEMED TO COMPLY DRAWING DTC-2203 (Iss. B, 18/03/15).
  15. ALL MAINTENANCE STRUCTURES LOCATED WITHIN THE ROAD RESERVE & PROPOSED DRIVEWAYS FITTED WITH CLASS 'D' TRAFFICABLE LID.
- PCS PROVIDED FOR FUTURE LOT. CONSTRUCTOR CONFIRMED LOCATION OF BOUNDARY & PCS LOCATION WITH SITE SUPERINTENDENT AT TIME OF CONSTRUCTION.

**CONTACT DIAL BEFORE YOU DIG**

**CONSTRUCTION NOTES**

THE PROPOSED WORKS AS DETAILED HERE ON CONSTRUCTED IN ACCORDANCE WITH:

1. THE SEWERAGE CODE OF AUSTRALIA - WSA 02-2002-2.2 SYDNEY WATER EDITION VERSION 4-2017;
2. SYDNEY WATER'S DEEMED TO COMPLY DTC-2000 (Iss. C, 18/03/15), DTC-2120 (Iss. A 18/03/15), DTC-2203 (Iss. B 18/03/15), DTC-2220 (Iss. D 18/03/15), DTC-2221 (Iss. B 1/03/13) & DTC-2222 (Iss. C 18/03/15).
3. SITE SPECIFIC COMPACTION TESTS - REFER SHEET 2

THE CONSTRUCTOR HAD A COPY OF THESE DOCUMENTS ON SITE AT ALL TIMES.

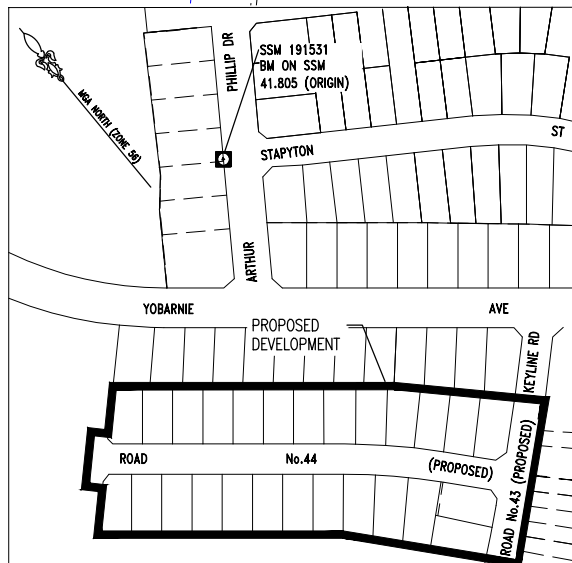

B.M. DIAGRAM & LOCALITY SKETCH  
(NOT TO SCALE)

04	WORK AS CONSTRUCTED	A.S.	02/02/21
03	FOR SMC APPROVAL	A.S.	23/07/20
02	FOR INFORMATION ONLY	A.S.	15/07/20
01	FOR SMC APPROVAL	A.S.	02/07/20

**PLEASE NOTE SITE SPECIFIC COMPACTION SPECIFICATION - SHEET 2**

**SITE SPECIFIC CONSTRUCTION NOTE**

- IT IS ACKNOWLEDGED THAT THERE IS RECENTLY CONSTRUCTED / COMPLETED INFRASTRUCTURE THROUGHOUT THE AREA OF PROPOSED WORKS, WITH OWNERSHIP SPREAD ACROSS SYDNEY WATER, COUNCIL AND REDBANK COMMUNITIES. THE CONSTRUCTOR IS AT ALL TIMES, TO UNDERTAKE WATER TASKS NECESSARY TO MINIMIZE DISTURBANCE AND DAMAGE TO EXISTING ROAD, KERB & GUTTER, FOOTPATH AND VEGETATION ETC, WITH ALL REPAIR AND RECTIFICATION TO MATCH THAT WHICH EXISTED PRIOR TO THE WORKS BEING UNDERTAKEN. PHOTOS OF EXISTING CONDITION WILL BE SUPPLIED TO BOTH THE PRINCIPAL CIVIL CONTRACTOR, SYDNEY WATER ACCREDITED SUBCONTRACTOR AND SUPERINTENDENT, TO CONFIRM THE PRE-WORKS CONDITION.

- SYDNEY WATER ACCREDITED SUBCONTRACTOR AT ALL TIMES, IS TO CONSULT WITH THE PRINCIPAL CIVIL CONTRACTOR, TO ENSURE THAT THE DEVELOPER, REDBANK COMMUNITIES IS ADVISED AND APPROVES THE EXTENT OF REQUIRED DISTURBANCE PRE-WORKS, IS ADVISED AND APPROVES OF ANY CHANGES TO THIS EXTENT DURING THE WORKS, AND INSPECTS AND ACCEPTS THE COMPLETED WORKS PRIOR TO THE SYDNEY WATER ACCREDITED SUBCONTRACTOR LOGGING THEIR PROJECT COMPLETION PACKAGE (PCP) WITH THE WATER SERVICE CO-ORDINATOR. WITH THIS ROLE UNDERTAKEN BY CALIBRE PROFESSIONAL SERVICES, CALIBRE PROFESSIONAL SERVICES ARE TO ONLY ACCEPT THE PCP FOR PROCESSING, PROVIDED THIS INSPECTION AND ACCEPTANCE BY REDBANK COMMUNITIES HAS BEEN RECEIVED IN WRITING WITH THE PCP.

REDBANK, SANDSTONE ARCH

PLAN TO BE READ IN CONJUNCTION WITH CURRENT SYDNEY WATER STANDARDS SYDNEY WATER CORPORATION PRIOR TO COMMENCEMENT OF EXCAVATION FOR PROPOSED AND EXISTING SERVICES CONTACT - DIAL BEFORE YOU DIG Ph: 1100 ELECTRICITY ENDEAVOUR ENERGY Ph: 131 003 GAS JENENA GAS Ph: 1300 880 906 TELECOMMUNICATIONS TELSTRA Ph: 1800 114 918 SYDNEY WATER Ph: 132 092 GIVING AT LEAST 48 HOURS NOTICE	<b>UTILITIES</b> TYPE DATE REF. TYPE DATE REF. SEWER: S 19/06/20 CALIBRE PROP STORMWATER: SWD SWD 05/06/20 JWP STORMWATER: SWD SWD 05/06/20 JWP PROP ELECTRICAL: E - - - - E 10/06/20 EPD ELECTRICAL: E - - - - E 10/06/20 EPD/DBYD PROP NBN: NBN - - - - NBN 20/05/20 DIT NBN: NBN - - - - NBN 23/06/20 DBYD PROP WATER: DN100 Water - - - - 15/07/20 CALIBRE WATER: Water - - - - 23/06/20 DBYD				<b>WORK AS CONSTRUCTED CERTIFICATION</b> DEVELOPER . . . REDBANK COMMUNITIES WATER SERVICE CO-ORDINATOR . . . CALIBRE PROFESSIONAL SERVICES PTY LTD CONSTRUCTOR . . . CAREY CONSTRUCTIONS PTY LTD COMPLETED . . . 11/12/2020 . . . W.A.C. PREPARED . . . 02/02/2021 DESIGNER . . . CALIBRE PROFESSIONAL SERVICES PTY LTD I CERTIFY THAT THE WORKS HAVE BEEN CONSTRUCTED IN ACCORDANCE WITH THE WORK AS CONSTRUCTED DRAWINGS.				<b>PIPE SCHEDULE</b> SIZE DN TYPE CLASS LENGTH PIPE JOINING METHOD / NOTES 150 U.P.V.C. SN8 428.85 RUBBER RING NO BOUNDARY TRAPS REQUIRED.				AUSTRALIAN HEIGHT DATUM SCALES PLAN : 1:500 SECTION { HOR. : 1:500 VERT. : 1:125 CROSS SECTIONS . . . . . NATURAL LENGTHS, DEPTHS & LEVELS ARE IN METRES.				NO AMENDMENTS ARE TO BE MADE TO THIS PLAN WITHOUT REFERENCE TO SYDNEY WATER. THIS PLAN IS NOT NECESSARILY UP TO DATE OR CORRECT AND SYDNEY WATER ACCEPTS NO RESPONSIBILITY. U.B. DIRECTORY . . . MAP 63_G16 (41st Edition) SHEET . 1 . OF . 2 . File No. N/A			
	PLAN TO BE READ IN CONJUNCTION WITH CURRENT SYDNEY WATER STANDARDS SYDNEY WATER CORPORATION PRIOR TO COMMENCEMENT OF EXCAVATION FOR PROPOSED AND EXISTING SERVICES CONTACT - DIAL BEFORE YOU DIG Ph: 1100 ELECTRICITY ENDEAVOUR ENERGY Ph: 131 003 GAS JENENA GAS Ph: 1300 880 906 TELECOMMUNICATIONS TELSTRA Ph: 1800 114 918 SYDNEY WATER Ph: 132 092 GIVING AT LEAST 48 HOURS NOTICE				THE SEWERAGE CODE OF AUSTRALIA - WSA 02-2002-2.2 SYDNEY WATER EDITION VERSION 4-2017; SYDNEY WATER'S DEEMED TO COMPLY DTC-2000 (Iss. C, 18/03/15), DTC-2120 (Iss. A 18/03/15), DTC-2203 (Iss. B 18/03/15), DTC-2220 (Iss. D 18/03/15), DTC-2221 (Iss. B 1/03/13) & DTC-2222 (Iss. C 18/03/15). SITE SPECIFIC COMPACTION TESTS - REFER SHEET 2 THE CONSTRUCTOR HAD A COPY OF THESE DOCUMENTS ON SITE AT ALL TIMES.				REDBANK, SANDSTONE ARCH SYDNEY WATER CORPORATION Case No. 184525WW HAWKESBURY SEWERAGE DRAINS TO NORTH RICHMOND S.T.W.											

PLAN DRAWN DATE: 02/02/2021 VERSION: 04 SHEET 1 OF 2 SHEETS

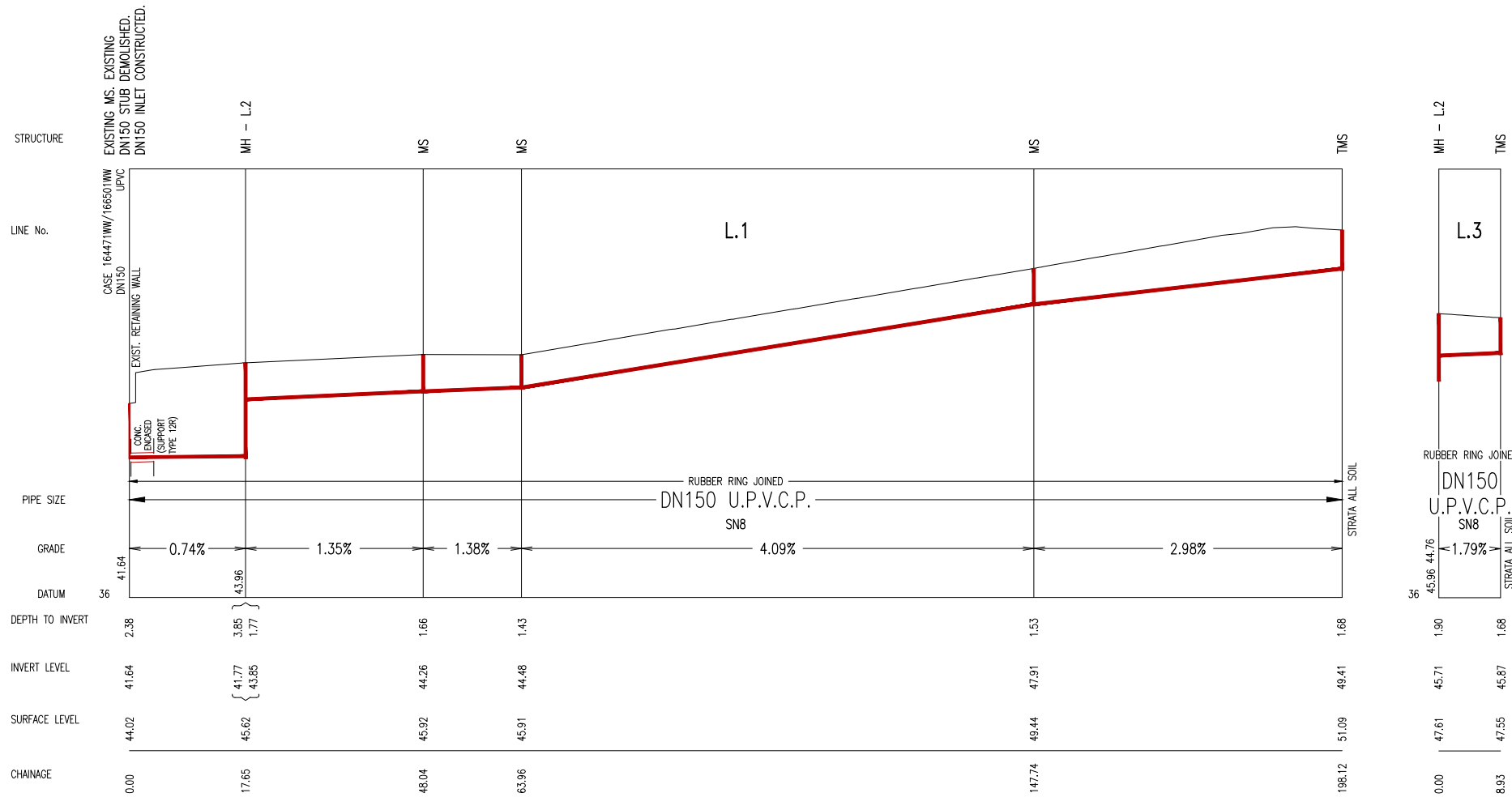

LINE NO	CHAINAGE	TYPE	DN RISER	COVER CLASS	MATERIAL (PVC, CAST IN-SITU, ETC)	MS DEFLECTION ANGLE	COMMENTS (BRAND, DTC, OTHER INFO)
1	0.00	EXISTING MS					REFER CN184471WW
1/2	17.65	MH	1050	B	CAST IN-SITU	N/A	DTC-2203
1	48.04	MS	0.225	B	UPVC	5	'AMYROO' TYPE OR EQUIV.
1	63.96	MS	0.225	B	UPVC	5	'AMYROO' TYPE OR EQUIV.
1	147.74	MS	0.225	B	UPVC	5	'AMYROO' TYPE OR EQUIV.
1	198.12	TMS	0.225	B	UPVC	N/A	'AMYROO' TYPE OR EQUIV.
2/3	43.84	MH	1050	B	CAST IN-SITU	N/A	DTC-2203
2	116.14	MS	0.225	B	UPVC	0	'AMYROO' TYPE OR EQUIV.
2	165.20	MS	0.225	B	UPVC	6	'AMYROO' TYPE OR EQUIV.
2	202.74	MS	0.225	D	UPVC	90	'POO PIT' TYPE OR EQUIV.
2	221.80	MS	0.225	B	UPVC	N/A	'AMYROO' TYPE OR EQUIV.
3	8.93	TMS	0.225	D	UPVC	N/A	'AMYROO' TYPE OR EQUIV.

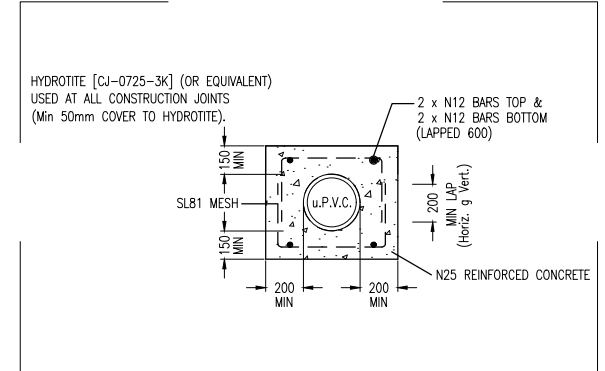
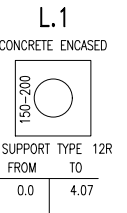

REINFORCED CONCRETE (12R)  
ENCASEMENT DETAIL  
(NOT TO SCALE)

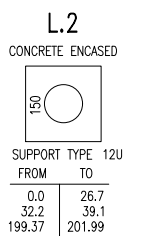
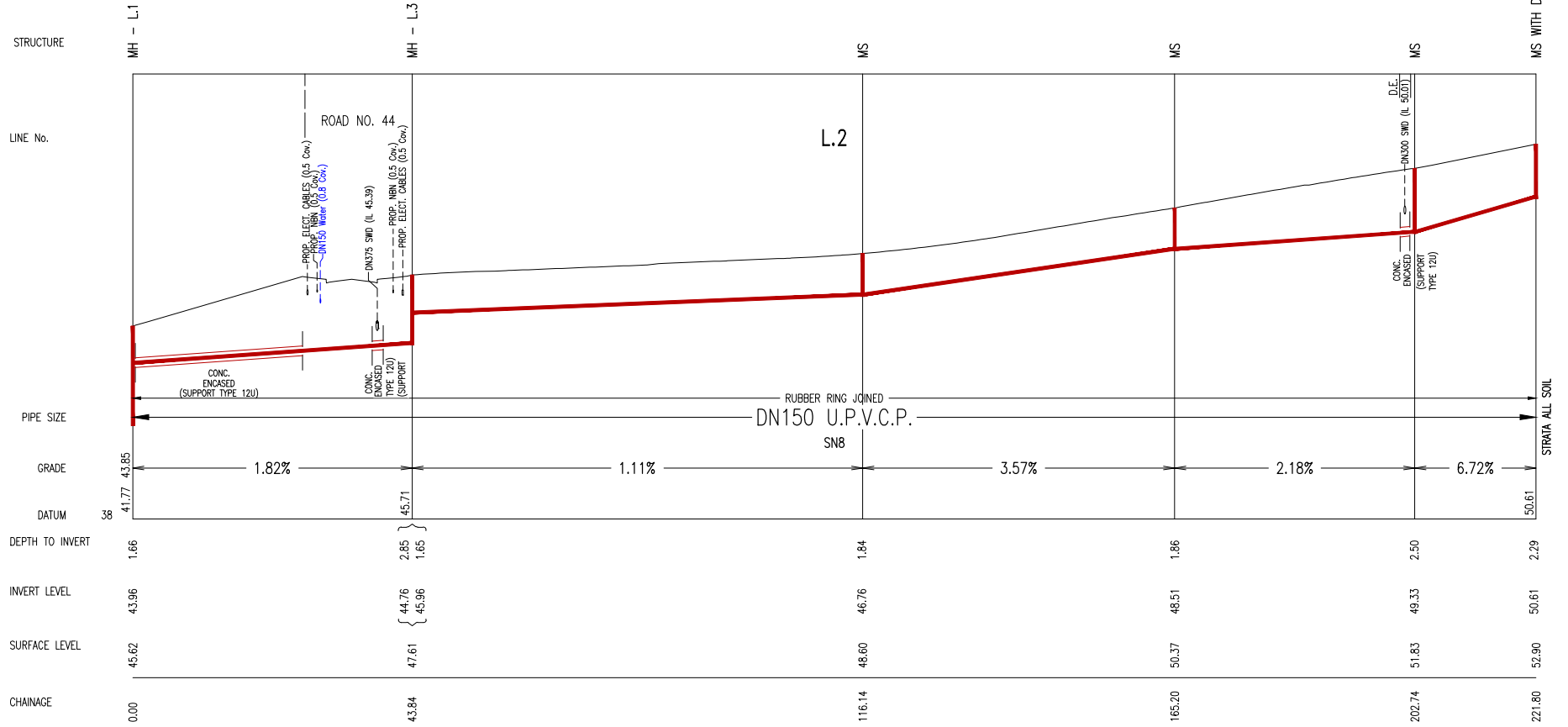

**SITE SPECIFIC COMPACTION SPECIFICATION**

**WITHIN FULL WIDTH OF ROAD CARBAGEWAY PLUS 1.0M EITHER SIDE -**

- ALL SUBGRADE SHALL BE CARRIED UP IN HORIZONTAL LAYERS, OF NOT MORE THAN 300MM THICK LOOSE MEASUREMENT, IF REQUIRED, AND SHALL HAVE EACH LAYER COMPACTED TO A 100% STANDARD DRY DENSITY RATIO DETERMINED IN ACCORDANCE WITH AS 1289 5.4.1-2007 'COMPACTION CONTROL TEST - DRY DENSITY RATIO, MOISTURE VARIATION AND MOISTURE RATIO'.
- ALL SUB-BASE COURSE SHALL BE PLACED AND COMPACTED TO AT LEAST 98% MODIFIED DRY DENSITY RATIO DETERMINED IN ACCORDANCE WITH AS 1289 5.4.1-2007 'COMPACTION CONTROL TEST - DRY DENSITY RATIO, MOISTURE VARIATION AND MOISTURE RATIO'.
- ALL BASE COURSE SHALL BE PLACED AND COMPACTED TO AT LEAST 98% MODIFIED DRY DENSITY RATIO DETERMINED IN ACCORDANCE WITH AS 1289 5.4.1-2007 'COMPACTION CONTROL TEST - DRY DENSITY RATIO, MOISTURE VARIATION AND MOISTURE RATIO'.
- ALL ROAD CROSSINGS TO BE PROVIDED IN EXISTING ROADS, THE TRENCHES SHALL BE BACKFILLED AND COMPACTED WITH A SAND/CEMENT BLEND 20:1 MIX TO SUBGRADE LEVEL, THEN COVERED TO WITHIN 50MM OF THE ROAD SURFACE, OR IF REQUIRED TO A HIGHER SPECIFICATION BY A SPECIFIC UTILITY AUTHORITY, TO THAT SPECIFICATION AS INSTRUCTED BY THE PROJECT SUPERINTENDENT.
- ALL TESTS TO BE TAKEN EVERY 50 METRE LENGTH OF PAVEMENT, TAKEN 1.0M FROM ALTERNATE SIDES OF PAVEMENT, BY A NATA REGISTERED LABORATORY.
- THESE AND ALL OTHER REQUIREMENTS TO BE COMPLIED WITH, TO BE READ IN CONJUNCTION WITH HAWKESBURY CITY COUNCIL DCP PART II - CONSTRUCTION SPECIFICATION.
- ANY ERRORS, OMISSIONS OR QUERIES TO BE SUBMITTED TO THE PROJECT SUPERINTENDENT FOR INSTRUCTION.

**WITHIN FULL WIDTH OF ROAD FOOTPATH / VERGE EXCLUDING 1.0M BESIDE ROAD CARBAGEWAY EITHER SIDE -**

- ALL FILL SHALL BE CARRIED OUT IN HORIZONTAL LAYERS, EXTENDING THE FULL WIDTH OF THE AREA BEING FILLED, OF NOT MORE THAN 300MM CONSOLIDATED THICKNESS. EACH LAYER SHALL BE COMPACTED TO AT LEAST 98% STANDARD DRY DENSITY RATIO DETERMINED IN ACCORDANCE WITH AS 1289 5.4.1-2007 'COMPACTION CONTROL TEST - DRY DENSITY RATIO, MOISTURE VARIATION AND MOISTURE RATIO'.
- ALL TESTS TO BE TAKEN EVERY 50 METRE LENGTH OF ROAD FOOTPATH / VERGE ON CENTRELINE, BY A NATA REGISTERED LABORATORY.
- ALL TRENCHES TO BE BACKFILLED TO HAVE THE SAME COMPACTION AS THE SURROUNDING ROAD FOOTPATH / VERGE.
- ALL TRENCH TESTS TO BE TAKEN IN EACH 300MM LAYER AND EVERY 50 METRES OF TRENCH, BY A NATA REGISTERED LABORATORY.
- THESE AND ALL OTHER REQUIREMENTS TO BE COMPLIED WITH, TO BE READ IN CONJUNCTION WITH HAWKESBURY CITY COUNCIL DCP PART II - CONSTRUCTION SPECIFICATION.
- ANY ERRORS, OMISSIONS OR QUERIES TO BE SUBMITTED TO THE PROJECT SUPERINTENDENT FOR INSTRUCTION.

**WITHIN LOTS -**

- ALL FILL SHALL BE CARRIED OUT IN HORIZONTAL LAYERS, EXTENDING THE FULL WIDTH OF THE AREA BEING FILLED, OF NOT MORE THAN 300MM CONSOLIDATED THICKNESS. EACH LAYER SHALL BE COMPACTED TO A DENSITY OF AT LEAST 98% STANDARD DRY DENSITY RATIO DETERMINED IN ACCORDANCE WITH AS 1289 5.4.1-2007 'COMPACTION CONTROL TEST - DRY DENSITY RATIO, MOISTURE VARIATION AND MOISTURE RATIO'. THE DEPTHS OF FILL AND THE COMPACTION THEREOF ARE TO BE VERIFIED BY THE SUBMISSION OF COMPACTION CERTIFICATES AND A PLAN SHOWING CONTROLLED DEPTHS OF FILL IN RELATION TO LOT BOUNDARIES.
- ALL TESTS TO BE A MINIMUM OF TWO COMPACTION TESTS PER LOT PER LAYER ARE TO BE CARRIED OUT, BY A NATA REGISTERED LABORATORY.
- ALL TRENCHES TO BE BACKFILLED TO HAVE THE SAME COMPACTION AS THE SURROUNDING LOTS.
- ALL TRENCH TESTS TO BE TAKEN IN EACH 300MM LAYER AND EVERY 50 METRES OF TRENCH, BY A NATA REGISTERED LABORATORY.
- THESE AND ALL OTHER REQUIREMENTS TO BE COMPLIED WITH, TO BE READ IN CONJUNCTION WITH HAWKESBURY CITY COUNCIL DCP PART II - CONSTRUCTION SPECIFICATION.
- ANY ERRORS, OMISSIONS OR QUERIES TO BE SUBMITTED TO THE PROJECT SUPERINTENDENT FOR INSTRUCTION.

WORK AS CONSTRUCTED CERTIFICATION		SYDNEY WATER CORPORATION	
DEVELOPER	REDBANK COMMUNITIES	<b>Sydney WATER</b>	
W.S.C.	CALIBRE PROFESSIONAL SERVICES PTY LTD	Case No. 184525WW	SHT 2 OF 2 SHTS.
CONSTRUCTOR	CAREY CONSTRUCTIONS PTY LTD		
COMPLETED	11/12/2020		
W.A.C. PREPARED	02/02/2021		
DESIGNER	CALIBRE PROFESSIONAL SERVICES PTY LTD.	SYDNEY WATER CORPORATION	
I CERTIFY THAT THE WORKS HAVE BEEN CONSTRUCTED IN ACCORDANCE WITH THE WORK AS CONSTRUCTED DRAWINGS		FOR DETAILS OF SERVICES SEE SHEET 1	