

WORK COMPLETED / FIELD BOOK

CONSTRUCTED BY

WORKS COMPLETED

SIGNATURE DATE

INSPECTED BY

SIGNATURE DATE

ASSET RECORDING

.....

OF

CONTACT No.

HEREBY CERTIFY THAT ASSETS MARKED AS-BUILT ON THIS DRAWING HAVE BEEN RECORDED AS PER ENDEAVOUR ENERGY STANDARD SAD 0004.

SIGNATURE DATE

HV. TRENCH LENGTH	-m
LV. TRENCH LENGTH	420m
TOTAL TRENCH LENGTH	420m

WARNING

LIVE ENDEAVOUR ENERGY CABLES AND OTHER SERVICES EXIST IN THIS AREA. PLEASE CONTACT - 'DIAL BEFORE YOU DIG' ON TEL:-1100 FOR SEARCH INFORMATION A MINIMUM TWO DAYS PRIOR TO EXCAVATION.

- NOTES**
- THIS DRAWING IS TO BE READ IN CONJUNCTION WITH THE RELEVANT ENDEAVOUR ENERGY NETWORK STANDARDS & CONNECTION POLICY.
 - REFER TELSTRANBN DESIGN LAYOUT FOR DUCTING AND EXCAVATION REQUIREMENTS.
 - ATTENTION - PERMANENT SURVEY MARKS MAY EXIST IN THIS AREA. THESE ARE TO BE LOCATED BY A SURVEYOR PRIOR TO THE COMMENCEMENT OF WORK.
 - WARNING - LIVE ENDEAVOUR ENERGY CABLES AND OTHER SERVICES IN THIS AREA. PLEASE CONTACT - 'DIAL BEFORE YOU DIG' ON TEL:-1100 FOR SEARCHES A MINIMUM TWO DAYS PRIOR TO EXCAVATION.
 - ALL THE REQUIREMENTS OF THE ENVIRONMENTAL PROTECTION AUTHORITY POLLUTION CONTROL LEGISLATION IS TO BE STRICTLY ADHERED TO.
 - THE DEVELOPER SHALL PROVIDE UNRESTRICTED 24/7 ACCESS FOR ENDEAVOUR ENERGY STAFF AND VEHICLES.

ALL WORKS TO BE CONSTRUCTED ARE TO BE COMPLETED IN ACCORDANCE WITH ENDEAVOUR ENERGY'S GENERIC ENVIRONMENTAL PLAN - EMS 0001.

ALL SL. COLUMNS ARE TO BE INSTALLED 350mm FROM THE FRONT PROPERTY BOUNDARIES UNLESS SHOWN OTHERWISE.

AHIP No. C0002175 APPLIES TO THIS PROJECT. LEVEL 1 ASP TO READ & FAMILIARISE HIMSELF WITH THE REQUIREMENTS OF THE DOCUMENT PRIOR TO THE COMMENCEMENT OF PROPOSED WORKS.

BEWARE - EX. HV. & LV. CABLES IN THIS AREA.

BEWARE - EX. LV. & SL. CABLES IN THIS AREA.

LEGEND

- EXISTING PADMOUNT SUBSTATION
- PROPOSED LV PILLAR LOCATION
- EXISTING LV PILLAR LOCATION
- PROPOSED S.L. COLUMN LOCATION
- EXISTING S.L. COLUMN LOCATION
- LV CABLE TRENCH
- EXISTING UNDERGROUND CABLE
- INSTALL 40mm PVC SERVICE CONDUIT
- EXISTING SERVICE CONDUIT
- PROPOSED DUCT LOCATIONS
- EXISTING DUCT LOCATIONS
- DUCT CONFIGURATION - REFER MCI 0006 SECTION 4

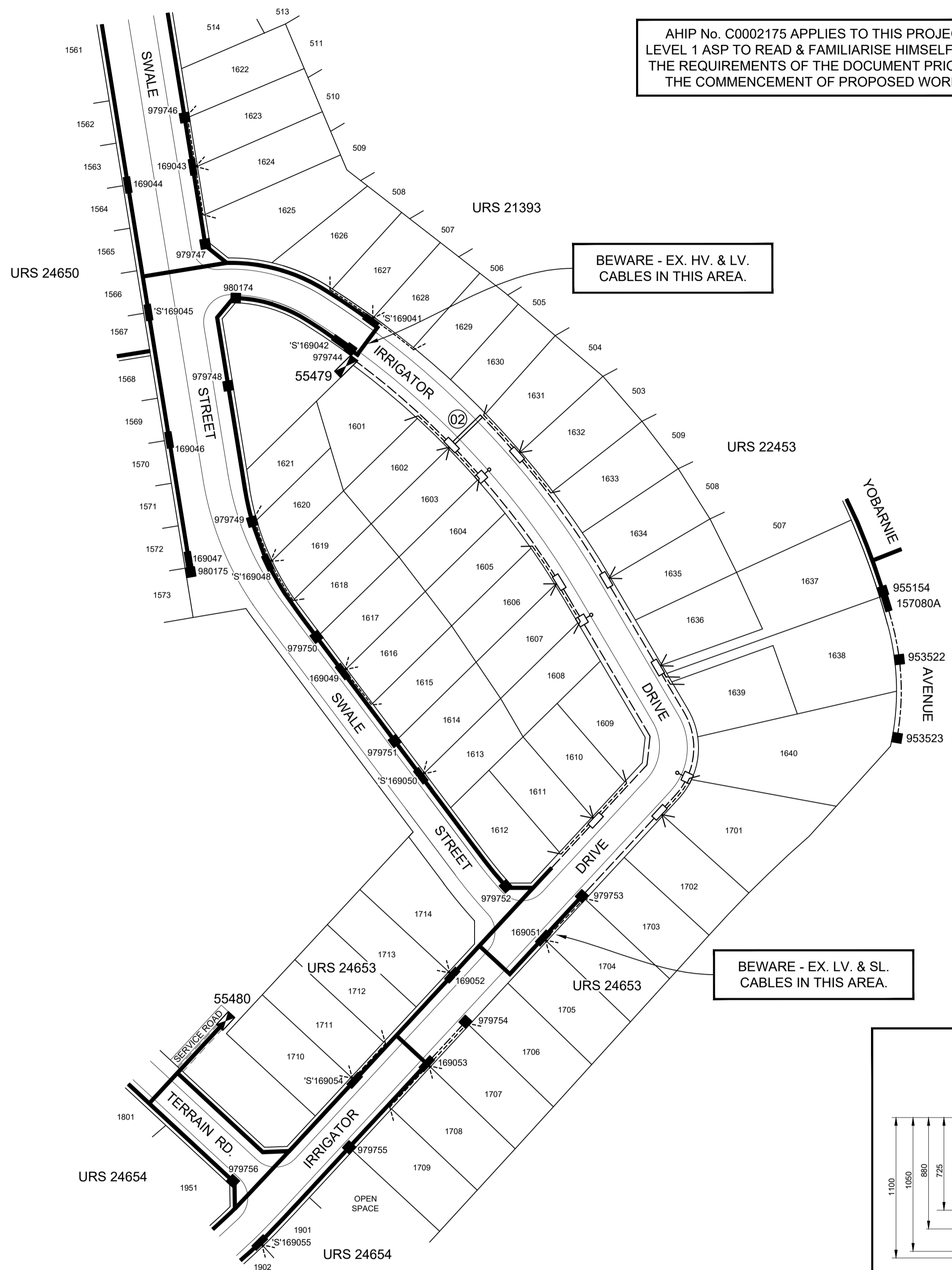

DUCT DECLARATION

.....

OF

CONTACT NUMBER

HEREBY CERTIFY THAT THE DUCTS SHOWN ON THIS DRAWING HAVE BEEN INSTALLED IN ACCORDANCE WITH THIS DRAWING AND ENDEAVOUR ENERGY STANDARDS MDI 0028 & MCI 0006. THE DUCT DEPTHS AND LOCATIONS AT EACH END HAVE BEEN CORRECTLY MARKED ON THIS DRAWING AS PER ENDEAVOUR ENERGY STANDARD SAD 0004.

THE INSTALLATION OF THE DUCTS WAS

COMMENCED ON

& COMPLETED ON

SIGNATURE

DATE

DEVELOPER COMPETENT PERSON

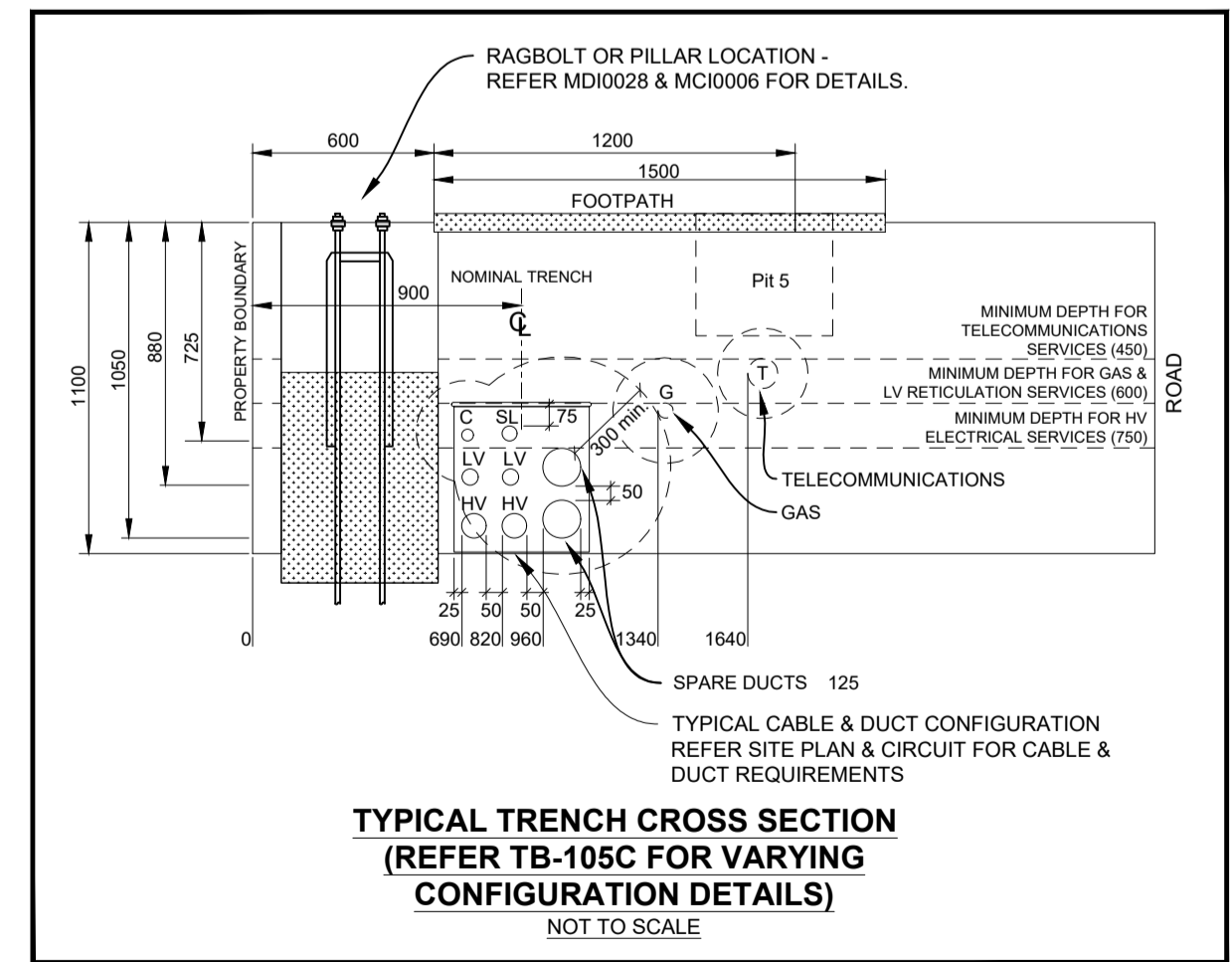
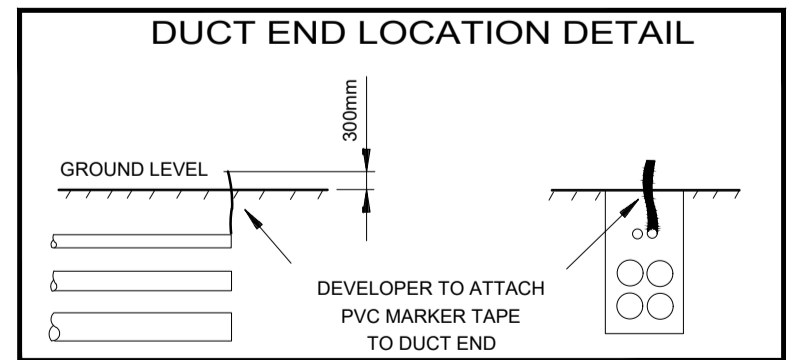

DESIGN COMPLIANCE AND INDEMNITY

This design complies with the Endeavour Energy's relevant standards as current at this time and as listed on the Endeavour Energy Accredited Service Provider's internet site. These standards include, but are not limited to:

- CP : Connection Policy
- EMS : Environmental Management Standard
- MCI : Mains Construction Instruction
- MDI : Mains Design Instruction
- PDI : Protection Design Instruction
- SDI : Substation Design Instruction
- SAD 0001 : Design Drawing Standard
- MMI : Mains Maintenance Instruction
- SMI : Substation Maintenance Instruction
- LDI 0001 : Public Lighting Electrical Design Element

Additionally, where relevant, the design complies with AS/NZS 7000 "Overhead Line Design - Detailed Procedures" published by the Australian Standards.

ESTATE POWER DESIGN (Company name) indemnifies Endeavour Energy for any loss or damage resulting from non-compliance of the design with the above standards.

Signed:

Name: BRIAN JUDE

Service Provider Number: 1033 Date: 23/08/2021

CERTIFIED BY ENDEAVOUR ENERGY

AMENDMENT: A

DATE APPROVED: 25/08/2021

EXAMINER'S SIGNATURE: Vishal Chavan

PRINT NAME: Vishal Chavan

THIS CERTIFICATION IS ISSUED SUBJECT TO ENDEAVOUR ENERGY'S STANDARD CERT. TERMS.

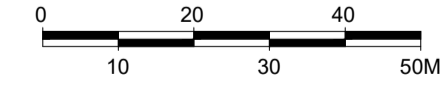

EPD REFERENCE No. 10/233/SH1&2D

ESTATE POWER DESIGN PTY LIMITED

ABN 69 002 331 142

ELECTRICAL RETICULATION CONSULTANTS

P.O. BOX 1872, PENRITH BC, 2751

TEL: (02) 4731-8333 FAX (02) 4731-1594

EMAIL: brian@estatepower.com.au

EPD 4.3

THIS DRAWING AND THE COPYRIGHT THEREIN IS THE PROPERTY OF ENDEAVOUR ENERGY AND MAY NOT BE COPIED, REPRODUCED, DISTRIBUTED, LOANED OR USED WITHOUT THE WRITTEN CONSENT OF ENDEAVOUR ENERGY

REFERENCE DRAWING'S	WORK ORDERS	CAP / SAMP No.	URS 24651
522860	ELECTRICAL RETICULATION	AM PROJ No.	-
	GENERAL	HV SWITCHING	-
	OVERHEAD	UBD/PENGUIN REF	MAP 63 REF J16
	UNDERGROUND	GIS MAP No.	6475.32
	SUBSTATIONS	HV OP DIAGRAM	NORTH RICHMOND
		LOCAL GOV AREA	HAWKESBURY

ORIGINAL SCALE	1:1000
DRAWN	E.C.
DATE	23.08.21
CHD	B.J.

DO NOT SCALE DIMENSIONS IN METRES

DESIGN B.J.

'SOUTHERN HEIGHTS' STAGE SH1&2 NORTH RICHMOND URS 24651 DUCT & TRENCH REQUIREMENTS

Endeavour Energy

A1 522859 A

SHEET No. 1 OF 1 SHEETS

WORK COMPLETED / FIELD BOOK

CONSTRUCTED BY

WORKS COMPLETED

SIGNATURE DATE

INSPECTED BY

SIGNATURE DATE

ASSET RECORDING

.....

OF

CONTACT No.

HEREBY CERTIFY THAT ASSETS MARKED AS-BUILT ON THIS DRAWING HAVE BEEN RECORDED AS PER ENDEAVOUR ENERGY STANDARD SAD 0004.

SIGNATURE DATE

KEY DOCUMENTS TABLE

THE CERTIFICATION OF THIS PRODUCT IS SUPPORTED BY THE FOLLOWING KEY DOCUMENTS -

DOCUMENT NAME	NOTATION DATE
SUMMARY ENVIRONMENTAL REPORT (SER) - FAT0038 PART OF EMS0001	3.8.21
AGREEMENT FOR ENTRY, GRANT AND CREATION OF EASEMENT - FPJ45013.	-
EQUIPMENT TO BE RETURNED TO ENDEAVOUR ENERGY - FPJ4252 (SWITCH GEAR TRANSFORMERS & BARE COPPER CONDUCTOR).	-
EQUIPMENT TO BE RETURNED TO ENDEAVOUR ENERGY - FPJ4253 (TREATED TIMBER POLES AND CONCRETE POLES).	-
TELECOMMUNICATION ASSET AGREEMENT - FPJ4184.	-
PROJECT DEFINITION.	-
ESTATE POWER DESIGN SAFETY REPORT.	3.8.21

WARNING

LIVE ENDEAVOUR ENERGY CABLES AND OTHER SERVICES EXIST IN THIS AREA. PLEASE CONTACT - 'DIAL BEFORE YOU DIG' ON TEL:-1100 FOR SEARCH INFORMATION A MINIMUM TWO DAYS PRIOR TO EXCAVATION

AHIP No. C0002175 APPLIES TO THIS PROJECT. LEVEL 1 ASP TO READ & FAMILIARISE HIMSELF WITH THE REQUIREMENTS OF THE DOCUMENT PRIOR TO THE COMMENCEMENT OF PROPOSED WORKS.

BEWARE - EX. HV. & LV. CABLES IN THIS AREA.

BEWARE - EX. LV. & SL. CABLES IN THIS AREA.

- NOTES
- THIS DRAWING IS TO BE READ IN CONJUNCTION WITH THE RELEVANT ENDEAVOUR ENERGY NETWORK STANDARDS, CONNECTION POLICY & THE DUCT AND TRENCH REQUIREMENTS DRAWING.
 - ENDEAVOUR ENERGY CONTACT PHONE No. 131081.
 - DESIGN CERTIFICATION SHALL LAPSE WHERE:
 - (i) NOTICE OF INTENT HAS NOT BEEN RECEIVED WITHIN SIX (6) MONTHS OF THIS CERTIFICATION OR
 - (ii) CONSTRUCTION HAS BEEN INTERRUPTED FOR MORE THAN SIX (6) MONTHS. WHERE DESIGN CERTIFICATION HAS LAPSED, THE DESIGN MUST BE RESUBMITTED FOR CERTIFICATION BY THE ACCREDITED DESIGNER.
 - ATTENTION - PERMANENT SURVEY MARKS MAY EXIST IN THIS AREA. THESE ARE TO BE LOCATED BY A SURVEYOR PRIOR TO THE COMMENCEMENT OF WORK.
 - ATTENTION - ALL SERVICES SEARCHES MUST BE CHECKED BEFORE CONSTRUCTION.
 - WARNING - LIVE ENDEAVOUR ENERGY CABLES AND OTHER SERVICES IN THIS AREA. PLEASE CONTACT - 'DIAL BEFORE YOU DIG' ON TEL:-1100 FOR SEARCHES A MINIMUM TWO DAYS PRIOR TO EXCAVATION
 - ATTENTION - SERVICE PROVIDER TO NOTIFY ENDEAVOUR ENERGY'S ASSET DATA CUSTOMER DEPT. DAILY WHEN CABLE WORKS IS IN PROGRESS. TELEPHONE 131 081.
 - OPERATIONAL LIMITS - UNLESS APPROVED OTHERWISE, INTERRUPTIONS TO ANY CUSTOMER'S SUPPLY MUST BE AVOIDED. THE FOLLOWING ALTERNATIVES SHOULD BE CONSIDERED:
 - MOBILE GENERATORS OR SUBSTATIONS.
 - LIVE LINEMAN.
 - DESIGN ALTERNATIVES.
 - LOW VOLTAGE PARALLELS.
 - WORK PRACTICES / STANDARDS.
 THE COST IS TO BE FUNDED BY THE CUSTOMER / DEVELOPER.
 - HAVE ALL THE EXISTING ASSETS BEEN FIELD CHECKED AND ARE ACCURATE AT THE TIME OF DESIGN: YES / NO.
 - ALL NEW LANTERNS TO BE CONTROLLED BY PHOTO ELECTRIC CELLS.
 - THE DEVELOPER SHALL PROVIDE UNRESTRICTED 24/7 ACCESS FOR ENDEAVOUR ENERGY STAFF AND VEHICLES.
 - HATCHED LOTS MUST NOT BE CONNECTED UNTIL APPROPRIATE PAYMENTS ARE RECEIVED BY ENDEAVOUR ENERGY.

ALL WORKS TO BE CONSTRUCTED ARE TO BE COMPLETED IN ACCORDANCE WITH ENDEAVOUR ENERGY'S GENERIC ENVIRONMENTAL PLAN - EMS 0001.

ALL SL. COLUMNS ARE TO BE INSTALLED 350mm FROM THE FRONT PROPERTY BOUNDARIES UNLESS SHOWN OTHERWISE.

- LEGEND**
- EXISTING PADMOUNT SUBSTATION
 - PROPOSED LV PILLAR
 - EXISTING LV PILLAR
 - PROPOSED S.L. COLUMN (REFER TO SCHEDULE)
 - EXISTING S.L. COLUMN
 - LV CABLE TRENCH
 - INSTALL 40mm PVC SERVICE CONDUIT
 - EXISTING SERVICE CONDUIT
 - EXISTING UNDERGROUND CABLE
 - PROPOSED ROAD CROSSING DUCT LOCATIONS (INSTALLED UNDER CIVIL WORKS)
 - EXISTING DUCT LOCATIONS
 - PILLAR EARTHING LOCATIONS
 - LV ISOLATION SWITCH (CLOSED)
 - LV ISOLATION SWITCH (OPEN)

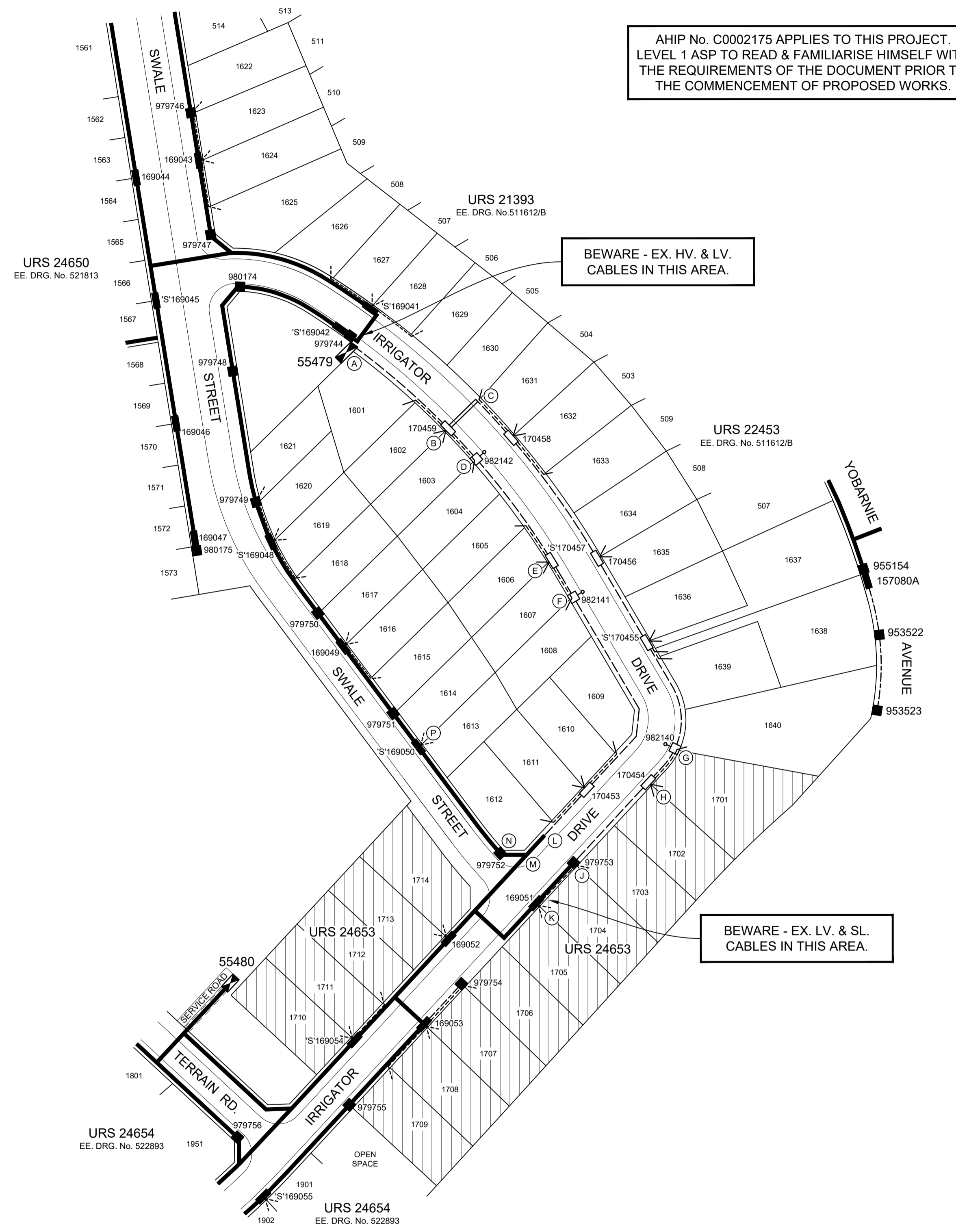

PIONEER COST SHARE REIMBURSEMENT SCHEME - EXPIRY DATE: N/A
PRO-RATA REIMBURSEMENT FOR CUSTOMER'S LOAD OVER 50kVA

ASSET	ASSET COST ESTIMATE (\$)	UNIT QUANTITY	NET ASSET CAPACITY (kVA)	ORIGINAL CUSTOMER UTILISATION (kVA)	MAXIMUM REIMBURSEMENT AMOUNT (\$)
HV. MAINS		(km)			
LV. MAINS		(km)			N/A
SUBSTATION					

DUCT INSTALLATION ACCEPTANCE BY THE ASP

I HAVE ACCEPTED THE CONDUITS AS MARKED UP ON THIS DRAWING IN COMPLIANCE TO SAD 0004 AND CONFIRM THAT:

ALL THE CONDUITS INSTALLED BY THE ASP ARE:

- * IN ACCORDANCE WITH MDI 0028 & MCI 0006.
- * ARE CORRECT AS PER THE WAE MARKED UP DESIGN PROVIDED.

ALL CONDUITS INSTALLED BUT THE DEVELOPER AS DETAILED IN THE DUCT AND TRENCH EASEMENT DRAWING HAVE BEEN CHECKED BY ME AND I VERIFY THAT:

- * STRING LINES ARE INSTALLED WITHIN ALL THE CONDUITS.
- * CONTINUITY OF ALL CONDUITS ARE CONFIRMED.
- * ALL END OF CONDUITS HAVE BEEN SEALED AS PER STANDARDS.
- * EXPOSED DUCTS AT OPEN ENDS APPEAR TO BE INSTALLED IN ACCORDANCE WITH MDI 0028 & MCI 0006.

THE INSTALLATION OF THE DUCTS WAS VERIFIED BY ME ON

NAME

SIGNATURE

DATE

ASP COMPANY

LEVEL 1 ASP COMPANY COMPETENT PERSON

DESIGN COMPLIANCE AND INDEMNITY

This design complies with the Endeavour Energy's relevant standards as current at this time and as listed on the Endeavour Energy Accredited Service Provider's Internet site. These standards include, but are not limited to:

- CP : Connection Policy
- EMS : Environmental Management Standard
- MCI : Mains Construction Instruction
- MDI : Mains Design Instruction
- PDI : Protection Design Instruction
- SDI : Substation Design Instruction
- SAD 0001 : Design Drawing Standard
- MMI : Mains Maintenance Instruction
- SMI : Substation Maintenance Instruction
- LDI 0001 : Public Lighting Electrical Design Element

Additionally, where relevant, the design complies with AS/NZS 7000 'Overhead Line Design - Detailed Procedures' published by the Australian Standards.

ESTATE POWER DESIGN (Company name)

indemnifies Endeavour Energy for any loss or damage resulting from non-compliance of the design with the above standards.

Signed:

Name: BRIAN JUDE

Service Provider Number: 1033 Date: 23/08/2021

CERTIFIED BY ENDEAVOUR ENERGY

AMENDMENT: A

DATE APPROVED: 25/08/2021

EXAMINER'S SIGNATURE: Vishal Chavan

PRINT NAME: Vishal Chavan

THIS CERTIFICATION IS ISSUED SUBJECT TO ENDEAVOUR ENERGY'S STANDARD CERT. TERMS.

APPROVAL TO CONNECT TO PUBLIC LIGHTING

REVIEWERS NAME: Vishal Chavan

DATE APPROVED: 25/08/2021

REVIEWERS SIGNATURE:

THIS APPROVAL IS ISSUED SUBJECT TO ENDEAVOUR ENERGY'S GENERAL TERMS & CONDITIONS FOR CONNECTION OF PUBLIC LIGHTING ASSETS & IS SPECIFICALLY FOR DRAWING No. 522860, AMENDMENT - A

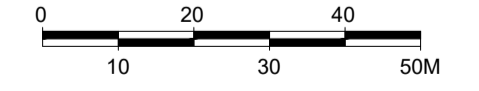

FUNDING ARRANGEMENTS FOR SCOPE OF WORKS

ASP LEVEL 1 ELECTRICAL WORKS		CUSTOMER	
ENDEAVOUR ENERGY SUPPLIED MATERIALS	CUSTOMER FUNDED NON-CONTESTABLE WORKS	CUSTOMER FUNDED	
NIL	SWITCHING, INSPECTION AND COMMISSIONING COSTS	INCLUDES BUT NOT LIMITED TO: - PEGGING OF PROPERTY BOUNDARIES AND INFRASTRUCTURE LOCATIONS.	
ENDEAVOUR ENERGY FUNDED & CONSTRUCTED	CUSTOMER FUNDED - CONTESTABLE	- PROVIDING ACCESS.	
WORKS REQUIRED PRIOR TO COMPLETION OF CUSTOMER CONTESTABLE PROJECT.	ALL OTHER WORKS & MATERIALS INCLUDING BUT NOT LIMITED TO: - INSTALLATION & ESTABLISHMENT OF THE LV NETWORK. - TRENCHING. - DUCT INSTALLATIONS. - CABLE LAYING AND / OR INSTALLATIONS. - JOINTING.	- OWN SERVICE & SERVICE CONNECTION. - CONFIRM FINISHED GROUND LEVELS.	
NIL	NIL	EXISTING DUCT USAGE CHARGE exc GST NIL (BASED ON REIMBURSEMENT RATES)	
ENDEAVOUR ENERGY CONTRIBUTED & ASP L1 CONSTRUCTED (REIMBURSED) (exc. GST)	NIL	COORDINATION SUPPLY REQUIRED DATE (TO BE CONFIRMED WITH PROJECT MANAGER) DAY: 21 MONTH: 10 YEAR: 2021	
NIL	NIL	ASSETS TO BE RETURNED TO THE NEAREST ENDEAVOUR ENERGY DEPOT BY LEVEL 1 ASP. NIL	

THIS DRAWING SUPPLIES 25 + 29 EX. LOTS

CAP No.	LOT No.	No. OF LOTS	DEVELOPER	DEVELOPER'S REF.	TEL No.
URS 24651	1601 - 1640	23 + 17 EX.	REDBANK COMMUNITIES	A. FLAHERTY	0419 474 960
URS 24653	1701 - 1714	2 + 12 EX.	REDBANK COMMUNITIES	A. FLAHERTY	0419 474 960

EXISTING LOTS SERVICED ON URS 24650 DRG. No. 521813

AUTHORISATION OF ESTIMATED VALUE OF ENDEAVOUR ENERGY FUNDED ASSETS

SIGNED:

PRINT NAME:

SERVICE NUMBER:

FUNDING AMOUNT \$:

DATE:

EPD REFERENCE No.
10/233/SH1&2R

A1 522860 A

SHEET No. 1 OF 2 SHEETS

ESTATE POWER DESIGN PTY LIMITED

ABN 69 002 331 142
ELECTRICAL RETICULATION CONSULTANTS
P.O. BOX 1872, PENRITH BC, 2751
TEL: (02) 4731-8333 FAX (02) 4731-1594
EMAIL: brian@estatepower.com.au

EPD 4.3

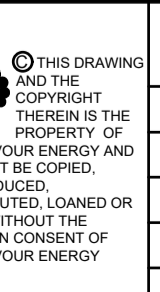

REFERENCE DRAWING'S	WORK ORDERS
522859 DUCT & TRENCH REQUIREMENTS	GENERAL
	OVERHEAD
	UNDERGROUND
	SUBSTATIONS

CAP / SAMP No.	URS 24651
AM PROJ. No.	-
HV SWITCHING	-
UBD/PENGUIN REF	MAP 63 REF J16
GIS MAP No.	6475.32
HV OP DIAGRAM	NORTH RICHMOND
LOCAL GOV AREA	HAWKESBURY

ORIGINAL SCALE	DO NOT SCALE
1:1000	DIMENSIONS IN METRES
DRAWN: E.C.	DESIGN: B.J.
DATE: 23.08.21	
CHD	

'SOUTHERN HEIGHTS'
STAGE SH1&2
NORTH RICHMOND
URS 24651
ELECTRICAL RETICULATION

AMENDMENTS ORIGINAL ISSUE

Cadastre: © Land and Property Information 2016

87998

WORK COMPLETED / FIELD BOOK

CONSTRUCTED BY

WORKS COMPLETED

SIGNATURE DATE

INSPECTED BY

SIGNATURE DATE

ASSET RECORDING

OF

CONTACT No.

HEREBY CERTIFY THAT ASSETS MARKED AS-BUILT ON THIS DRAWING HAVE BEEN RECORDED AS PER ENDEAVOUR ENERGY STANDARD SAD 0004.

SIGNATURE DATE

LIGHTING EQUIPMENT SCHEDULE																					
ITEM I.D.	STATE	SL. NUMBER	SUPPORT NUMBER	LUMINAIRE		RATE CODE	QTY	RAGBOLT	FOUNDATION	POLE / COLUMN		RATE CODE	QTY	OUTREACH		RATE CODE	QTY	UPCAST	LTG. CAT.	CHARGE TO	MOUNTING HEIGHT (m)
1	NEW	297877 - 297878	982140 - 982142	STREETLED03 17W 4K STANDARD VISOR	JLC99G05L17	889	3	TYPE 2	TYPE 2	4.5m ENLARGED BASE	IE / EB 4.5	995	3	3.0m STANDARD	IE 3.0 CPS/25	991	3	5'	PR5	HAWKESBURY COUNCIL	6.5m

PVC DUCT SCHEDULE								
NOTE - ALL TRENCH SECTIONS ARE TO BE READ & VIEWED FROM NODE TO NODE AS NOMINATED.								
NODE	DUCT CONFIG.	ROUTE LENGTH	CUSTOMER FUNDED	E.E FUNDED	E.E REIMBURSEMENT RATE PER METRE	ENDEAVOUR REIMBURSED	E.E EXISTING DUCT USAGE CHARGE	
A - B	LV. NEW	45m	1 x 125mm	-	-	-	-	
B - C	LV. NEW RD/CROSSING	-	INSTALLED & FUNDED UNDER CIVIL WORKS	-	-	-	-	
B - D	LV. NEW	13m	1 x 50mm 1 x 125mm	-	-	-	-	
D - E	LV. NEW	40m	1 x 125mm	-	-	-	-	
E - F	LV. NEW	15m	1 x 50mm 1 x 125mm	-	-	-	-	
F - L	LV. NEW	95m	1 x 125mm	-	-	-	-	
L - M	LV. EXIST.	-	-	-	-	-	NIL - DEV. FUNDED & INSTALLED UNDER URS 24650 DRG. 521813	
M - N	LV. EXIST.	-	-	-	-	-	NIL - DEV. FUNDED & INSTALLED UNDER URS 24650 DRG. 521813	
N - P	EX. SL. LV. EXIST.	-	-	-	-	-	NIL - DEV. FUNDED & INSTALLED UNDER URS 24650 DRG. 521813	
C - G	LV. NEW	130m	1 x 125mm	-	-	-	-	
G - H	LV. NEW	15m	1 x 50mm 1 x 125mm	-	-	-	-	
H - J	LV. NEW	35m	1 x 125mm	-	-	-	-	
J - K	LV. EXIST.	-	-	-	-	-	NIL - DEV. FUNDED & INSTALLED UNDER URS 24650 DRG. 521813	
TOTAL ROUTE LENGTH		388m	TOTAL ENDEAVOUR REIMBURSED		-			NIL.
TOTAL DUCT LENGTH		CUSTOMER FUNDED		EE REIMBURSED				
		50mm = 43m 125mm = 388m		50mm = NIL 125mm = NIL.				

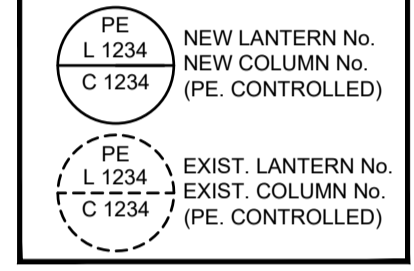

VD = VOLTAGE DROPS FOR NORMAL SUPPLY FROM PM. SUBSTATIONS @ 6.5 KVA.
 VD₂ = VOLTAGE DROPS FOR EMERGENCY / BACKUP FROM PM. SUB. 55479 TO PM. SUB. 55480 @ 3.9 KVA.
 VD₃ = VOLTAGE DROPS FOR EMERGENCY / BACKUP FROM PM. SUB. 55480 TO PM. SUB. 55479 @ 3.9 KVA.

FINAL LV. & SL. CIRCUIT

- X LAY 240 SQmm 4 CORE 1KV XLPE/PVC CABLE - RL. 520m CL. 580m
- Z LAY 2 x 16 SQmm 1 CORE CU PVC/PVC IN 50mm PVC CONDUIT OR ROAD CROSSING RL. 60m CL. 140m
- EXISTING UG. CABLE

- SCHEDULE SYMBOLS**
- DIRECT BURIED CABLE
 - SPARE 50mm DUCT CUSTOMER FUNDED
 - ⊙ SPARE 125mm DUCT CUSTOMER FUNDED
 - ⊕ SPARE 125mm DUCT ENDEAVOUR FUNDED (PROVIDE A MINIMUM 75mm COVER)
 - ⊖ DUCT WITH EXISTING CABLE
 - DUCT WITH NEW CABLE

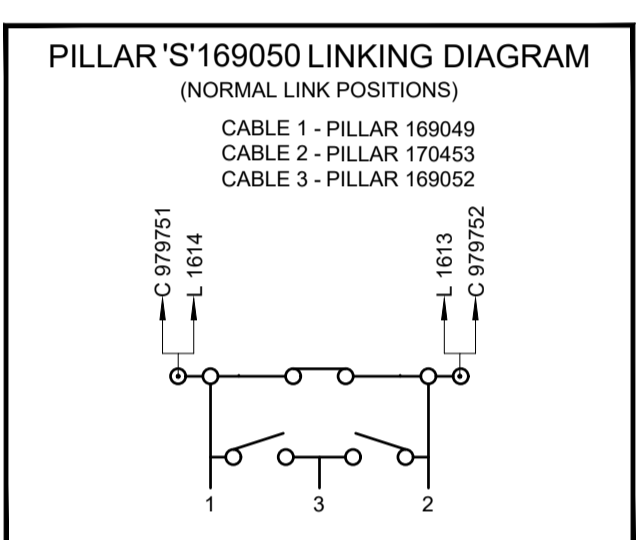
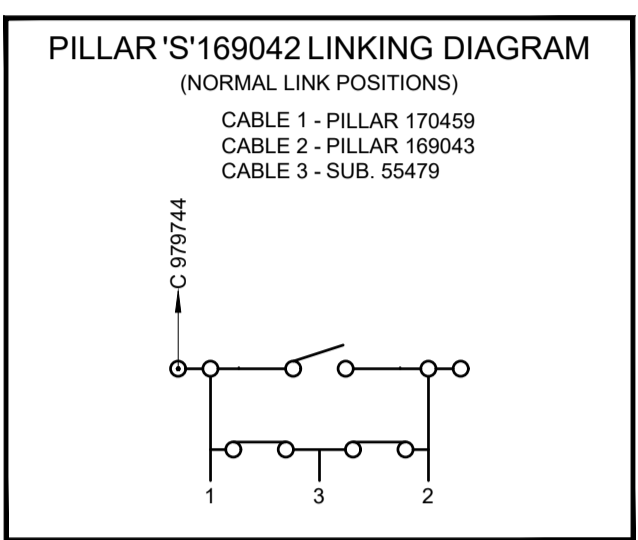
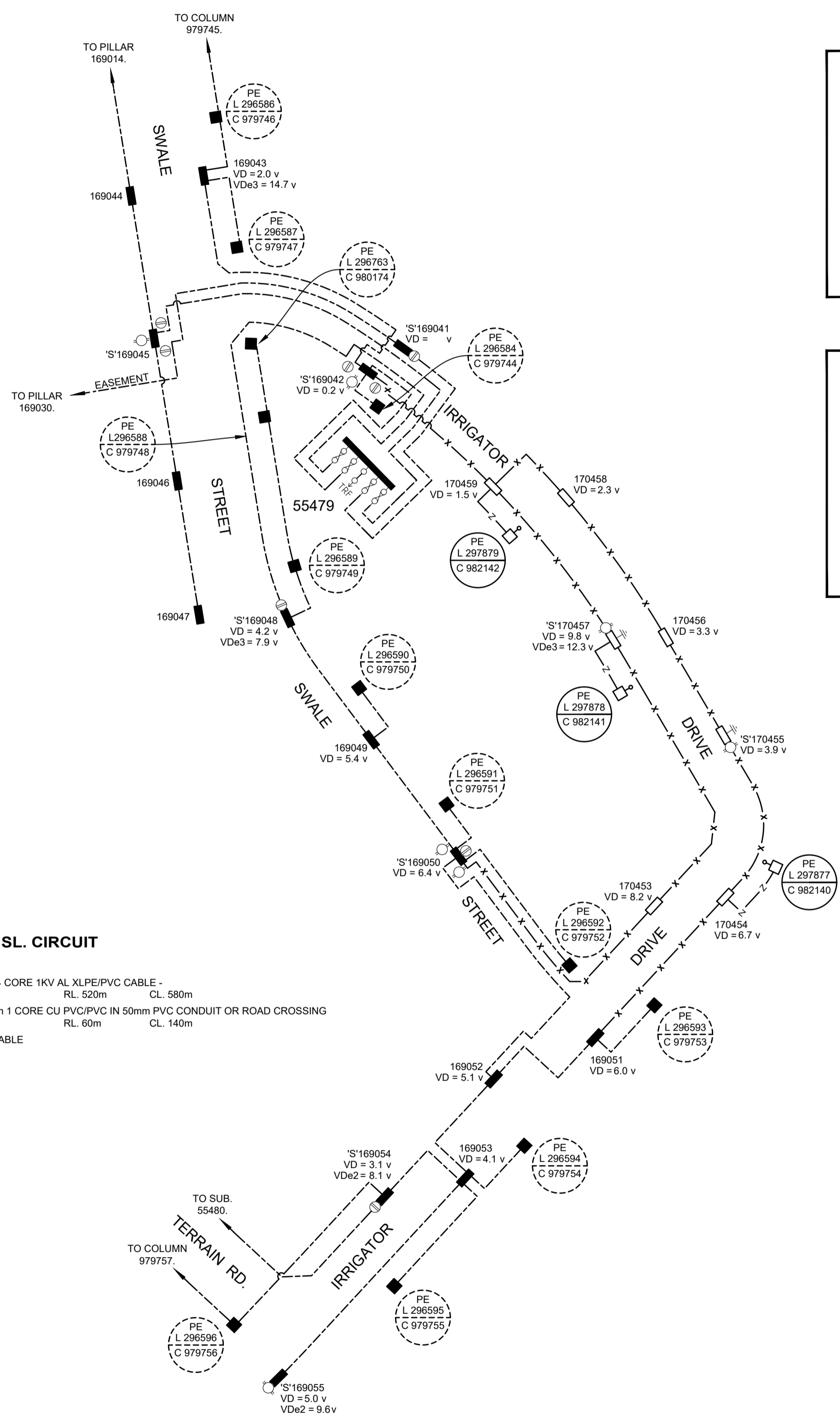

CERTIFIED BY ENDEAVOUR ENERGY
 AMENDMENT: A
 DATE APPROVED: 25/08/2021
 EXAMINER'S SIGNATURE: Vishal Chavan
 PRINT NAME: Vishal Chavan
 THIS CERTIFICATION IS ISSUED SUBJECT TO ENDEAVOUR ENERGY'S STANDARD CERT. TERMS.

EPD REFERENCE No.
 10/233/SH1&2R

ESTATE POWER DESIGN PTY LIMITED
 ABN 69 002 331 142
 ELECTRICAL RETICULATION CONSULTANTS
 P.O. BOX 1872, PENRITH BC, 2751
 TEL: (02) 4731-8333 FAX (02) 4731-1594
 EMAIL: brian@estatepower.com.au

REFERENCE DRAWING'S	WORK ORDERS	CAP / SAMP No.	URS 24651
522859	DUCT & TRENCH REQUIREMENTS	AM PROJ. No.	-
	GENERAL	HV SWITCHING	-
	OVERHEAD	UBD/PENGUIN REF	MAP 63 REF J16
	UNDERGROUND	GIS MAP No.	6475.32
	SUBSTATIONS	HV OP DIAGRAM	NORTH RICHMOND
		LOCAL GOV AREA	HAWKESBURY

ORIGINAL SCALE
 1:1000
 DO NOT SCALE DIMENSIONS IN METRES

'SOUTHERN HEIGHTS' STAGE SH1&2 NORTH RICHMOND URS 24651 ELECTRICAL RETICULATION

Endeavour Energy

A1 522860 A

SHEET No. 2 OF 2 SHEETS

Cadastre: © Land and Property Information 2016